

## Service Manual Supplement

## Micro Component System

## DC-DA3000 (AU)

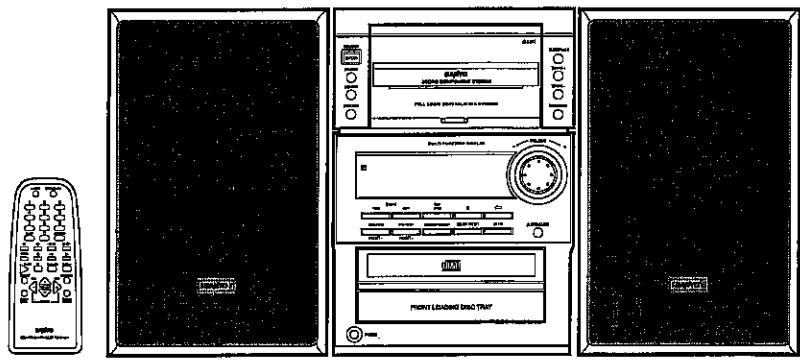

The construction of the model DC-DA3000/AU is similar to the model DC-BM300/AU. Please also refer to the original service manual DC-BM300/AU(SM5810341) for the items which do not appear in this supplement.

### Contents

PRODUCT CODE No.  
129 617 10

Exploded view (Cabinet & Chassis) .....	1
Parts list .....	2
Schematic diagram	
(FRONT) .....	4
Wiring diagram	
(FRONT) .....	6

This service manual consists of "DC-DA3000U/AU" (Main unit : 129 618 10) and  
 "SX-DA3000/UK" (Speaker system : 165 043 05).

EXPLODED VIEW (CABINET & CHASSIS)

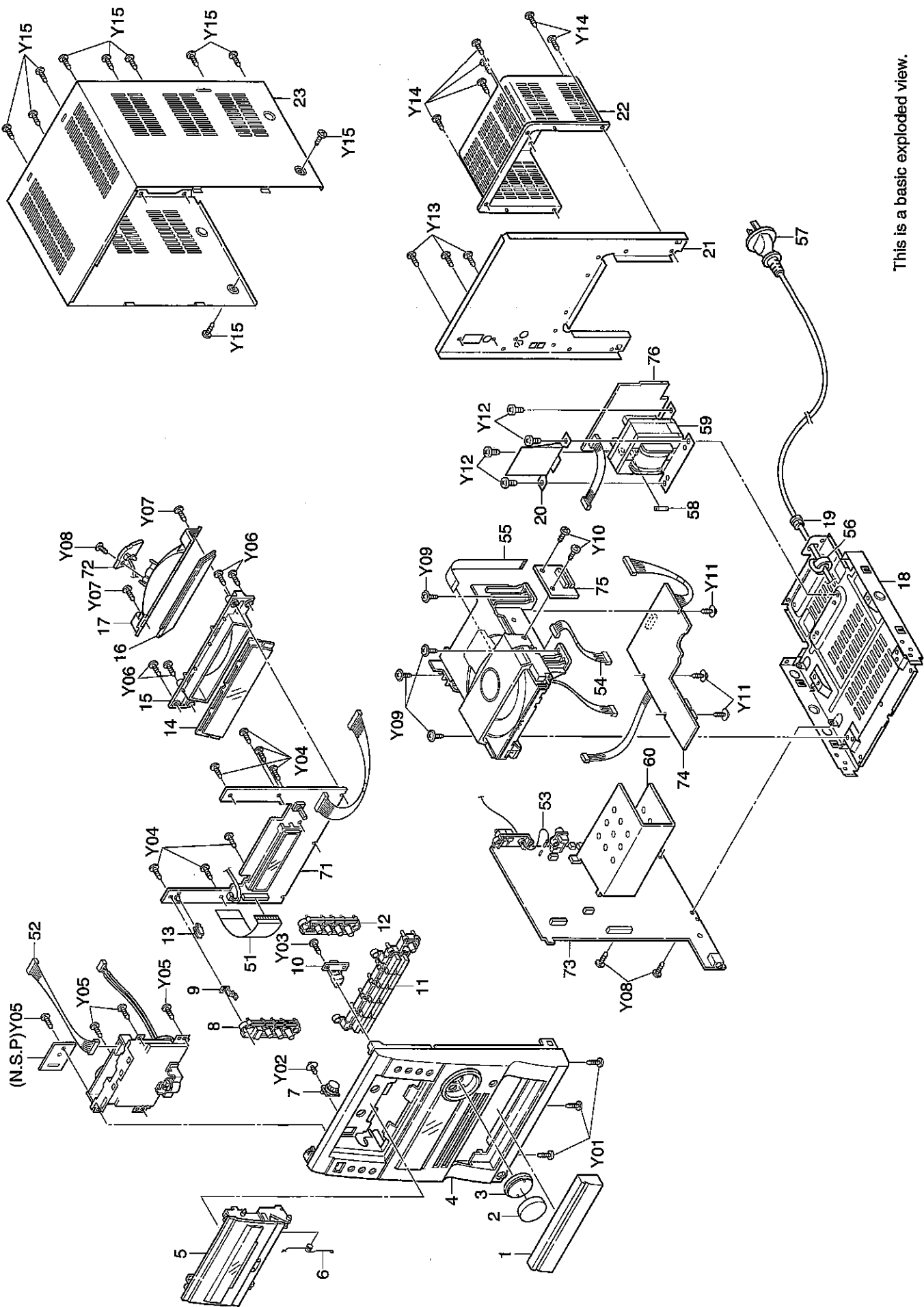

This is a basic exploded view.

## PARTS LIST

### PRODUCT SAFETY NOTICE

EACH PRECAUTION IN THIS MANUAL SHOULD BE FOLLOWED DURING SERVICING. COMPONENTS IDENTIFIED WITH THE IEC SYMBOL  $\Delta$  IN THE PARTS LIST AND THE SCHEMATIC DIAGRAM DESIGNATED COMPONENTS IN WHICH SAFETY AND PERFORMANCE CAN BE OF SPECIAL SIGNIFICANCE. WHEN REPLACING A COMPONENT IDENTIFIED BY  $\Delta$ , USE ONLY THE REPLACEMENT PARTS DESIGNATED, OR PARTS WITH THE SAME RATINGS OF RESISTANCE, WATTAGE OR VOLTAGE THAT ARE DESIGNATED IN THE PARTS LIST IN THIS MANUAL. LEAKAGE-CURRENT OR RESISTANCE MEASUREMENTS MUST BE MADE TO DETERMINE THAT EXPOSED PARTS ARE ACCEPTABLY INSULATED FROM THE SUPPLY CIRCUIT BEFORE RETURNING THE PRODUCT TO THE CUSTOMER.

**CAUTION :** Regular type resistors and capacitors are not listed. To know those values, refer to the schematic diagram.  
Regular type resistors are less than 1/4 W carbon type and 0 ohm chip resistors.  
Regular type capacitors are less than 50 V and less than 1000  $\mu$ F type of Ceramic type and Electrical type.

**N.S.P :** Not available as service parts.

### PACKING & ACCESSORIES

REF.NO.	PART NO.	DESCRIPTION
	614 326 0998	CARTON CASE
	614 323 0137	CUSHION, REAR
	614 323 0144	CUSHION, FRONT
	614 326 1025	INSTRUCTION MANUAL
	645 012 1302	POLY SHEET-1200X0550*NC, SET
	645 046 8322	ASSY, ANTENNA, LOOP
or	645 005 1227	ASSY, ANTENNA, LOOP
	614 318 9404	LID, BATTERY, SERVICE
	645 044 1110	REMOCON, ***
	614 245 0055	ANTENNA
	614 326 0776	ASSY, BOX, SPEAKER

### CABINET & CHASSIS

REF.NO.	PART NO.	DESCRIPTION
1	614 325 0456	COVER, CD, DOOR
2	614 318 6113	KNOB, VR
3	614 318 6045	DEC, VR
4	614 322 9995	ASSY, PANEL, FRONT
5	614 325 0395	ASSY, LID, CASSETTE
6	614 318 6267	SPRING, WIRE, LID, CASSETTE
7	614 309 8270	ASSY, GEAR, LID CASSETTE
8	614 326 0820	BUTTON, POWER, 4KEYS
9	614 318 7530	REFLECTOR, STANDBY, LED
10	614 303 1277	LATCH, CAM, DECK, DOOR, LOCKING
11	614 325 0425	BUTTON, PLAY, 11KEYS
12	614 326 0837	BUTTON, TUNER, 4KEYS
13	614 318 7486	HOLDER, STANDBY LED
14	614 318 6052	DEC, WINDOW, LED
15	614 318 6090	HOLDER, LED
16	614 318 6236	REFLECTOR
17	614 318 6106	HOLDER, REFLECTOR
18	614 322 9971	ASSY, CABINET, BOTTOM
19	614 284 1884	FIXER, AC CORD
or	614 129 1901	FIXER, AC CORD
20	614 324 5612	SHIELD, TRANSFORMER
21	614 326 0882	PANEL, REAR
22	614 323 0038	COVER, REAR
23	614 323 3398	CABINET, BENDING

### FIXING PARTS

The construction of "FIXING PARTS" (Ref.No.Y01~Y15) is similar to that of DC-BM300/AU.

### ELECTRICAL PARTS

The construction of "ELECTRICAL PARTS" (Ref.No.51~59) is similar to that of DC-BM300/AU.

### FRONT P.W.BOARD ASSY

REF.NO.	PART NO.	DESCRIPTION
71	614 326 0806	ASSY, PWB FRONT (Only Initial)
BR601	614 318 6991	HOLDER, FL, HOLDER-FL
C6011	403 262 8607	DL-ELECT 0.047F Z 5.5V
or	403 304 4802	DL-ELECT 0.047F Z 5.5V
CN601	645 012 5324	SOCKET, FPC 28P, FRONT-AMP
or	645 009 8482	SOCKET, FPC 28P
CN604	614 035 4911	SOCKET, DIP 2P, FRONT-LED
CN611	614 324 4646	ASSY, WIRE, FRONT-SOCKET 190L
D6010	407 012 4406	DIODE 1SS133
D6110	407 012 4406	DIODE 1SS133
D6111	407 012 4406	DIODE 1SS133
D6112	407 012 4406	DIODE 1SS133
D6115	407 099 4603	ZENER DIODE MTZJ3.9B
D6312	408 049 3905	LED SLP-9G118C-51HS-T1, STAND-BY-LED
D6313	407 225 7300	LED LT03B3-43-URE1
D6314	407 225 7300	LED LT03B3-43-URE1
FL601	645 054 9724	FLOURESCENT TUBE, FL
IC601	410 448 0201	IC LC866540A-50C9, MICON
L6010	645 001 5441	INDUCTOR, 2.2U K
Q6101	405 019 3804	TR 2SC536-G-NP
or	405 019 2708	TR 2SC536-F-NP
or	405 141 3208	TR KTC3198-Y
or	405 141 3307	TR KTC3198-GR
Q6107	405 141 3505	TR KTA1266-Y
or	405 141 3406	TR KTA1266-GR
or	405 004 4502	TR 2SA608-F-NP
or	405 004 5004	TR 2SA608-G-NP
Q6108	405 143 8706	TR KTC3199-GR
or	405 011 8500	TR 2SC1740S-R
or	405 011 8609	TR 2SC1740S-S
or	405 017 9600	TR 2SC3330-T
or	405 017 9709	TR 2SC3330-U
Q6201	405 000 6104	TR DTC144ES
or	405 146 1209	TR KRC104M
Q6202	405 146 1209	TR KRC104M
or	405 000 6104	TR DTC144ES
Q6301	405 143 0007	TR KRC107M
or	405 000 3806	TR DTC114YS
Q6302	405 143 0007	TR KRC107M
or	405 000 3806	TR DTC114YS
S6001	645 044 6535	SWITCH, ROTARY (ENCODER)
S6110	645 006 5958	SWITCH, PUSH 1P-1T
or	614 240 1002	SWITCH, TACT
or	614 220 5471	SWITCH, TACT
S6111	614 220 5471	SWITCH, TACT
or	614 240 1002	SWITCH, TACT
or	645 006 5958	SWITCH, PUSH 1P-1T
S6112	645 006 5958	SWITCH, PUSH 1P-1T
or	614 240 1002	SWITCH, TACT
or	614 220 5471	SWITCH, TACT
S6113	645 006 5958	SWITCH, PUSH 1P-1T
or	614 240 1002	SWITCH, TACT
or	614 220 5471	SWITCH, TACT
S6114	645 006 5958	SWITCH, PUSH 1P-1T
or	614 240 1002	SWITCH, TACT

PARTS LIST

REF.NO.	PART NO.	DESCRIPTION
or	614 220 5471	SWITCH,TACT
S6115	645 006 5958	SWITCH,PUSH 1P-1T
or	614 240 1002	SWITCH,TACT
or	614 220 5471	SWITCH,TACT
S6116	645 006 5958	SWITCH,PUSH 1P-1T
or	614 240 1002	SWITCH,TACT
or	614 220 5471	SWITCH,TACT
S6117	645 006 5958	SWITCH,PUSH 1P-1T
or	614 240 1002	SWITCH,TACT
or	614 220 5471	SWITCH,TACT
S6118	645 006 5958	SWITCH,PUSH 1P-1T
or	614 240 1002	SWITCH,TACT
or	614 220 5471	SWITCH,TACT
S6119	645 006 5958	SWITCH,PUSH 1P-1T
or	614 240 1002	SWITCH,TACT
or	614 220 5471	SWITCH,TACT
S6210	645 006 5958	SWITCH,PUSH 1P-1T
or	614 240 1002	SWITCH,TACT
or	614 220 5471	SWITCH,TACT
S6211	645 006 5958	SWITCH,PUSH 1P-1T
or	614 240 1002	SWITCH,TACT
or	614 220 5471	SWITCH,TACT
S6212	645 006 5958	SWITCH,PUSH 1P-1T
or	614 240 1002	SWITCH,TACT
or	614 220 5471	SWITCH,TACT
S6213	614 240 1002	SWITCH,TACT
or	614 220 5471	SWITCH,TACT
or	645 006 5958	SWITCH,PUSH 1P-1T
S6214	645 006 5958	SWITCH,PUSH 1P-1T
or	614 240 1002	SWITCH,TACT
or	614 220 5471	SWITCH,TACT
S6215	645 006 5958	SWITCH,PUSH 1P-1T
or	614 240 1002	SWITCH,TACT
or	614 220 5471	SWITCH,TACT
S6216	645 006 5958	SWITCH,PUSH 1P-1T
or	614 240 1002	SWITCH,TACT
or	614 220 5471	SWITCH,TACT
S6217	645 006 5958	SWITCH,PUSH 1P-1T
or	614 240 1002	SWITCH,TACT
or	614 220 5471	SWITCH,TACT
S6218	645 006 5958	SWITCH,PUSH 1P-1T
or	614 240 1002	SWITCH,TACT
or	614 220 5471	SWITCH,TACT
SE601	408 048 8604	PHOTO DIODE PIC-37243TE2
X6101	645 032 1627	OSC,CRYSTAL 32.768KHZ
X6102	645 018 6103	OSC,CERAMIC 6.000MHZ
or	645 057 1138	OSC,CERAMIC 6.0MHZ

POWER SUPPLY P.W.BOARD ASSY

The construction of "POWER SUPPLY P.W.BOARD ASSY"(Ref.No76) is similar to that of DC-BM300/AU.

TAPE MECHANISM (TM-DA370TN-SH)

The construction of "TAPE MECHANISM (TM-DA370TN-SH)" is similar to that of DC-BM300/AU.

CD MECHANISM (CD-BM500-SH)

The construction of "CD MECHANISM (CD-BM500-SH)" is similar to that of DC-BM300/AU.

SOCKET P.W.BOARD ASSY

The construction of "SOCKET P.W.BOARD ASSY"(Ref.No72) is similar to that of DC-BM300/AU.

AMPLIFIER & TUNER P.W.BOARD ASSY

The construction of "AMPLIFIER & TUNER P.W.BOARD ASSY"(Ref.No73) is similar to that of DC-BM300/AU.

CD P.W.BOARD ASSY

The construction of "CD P.W.BOARD ASSY"(Ref.No74) is similar to that of DC-BM300/AU.

CD LED P.W.BOARD ASSY

REF.NO.	PART NO.	DESCRIPTION
75	614 326 0790	ASSY,PWB CD LED(Only Initial)
CN645	614 035 4911	SOCKET,DIP 2P,FRONT-LED
D6401	407 225 7300	LED LT03B3-43-URE1,CD-TRAY-LED